

## Complete range of ceiling luminaires with IP 65 protection

The complete range enables you to choose the optimal product suitable for installation environment and lighting equipment requirements.



### **MAR**

- Polycarbonat body
- Prismatic polycarbonat cover
- Diffused Beam
- Optimized Dimensions
- Power input group HF GE
- Pre-arranged for different types of accesses
- T5 version available



### **MAX**

- Stainless steel body
- Smooth glass or polycarbonat cover
- Semiconcentrated beam



### **MAS**

- Polycarbonat body
- Smooth polycarbonat cover
- Concentrated beam



### **MAC**

- Fiberglass-reinforced polyester body
- Fluorescent lamp protected by polycarbonat cover
- Aluminium reflectors
- Diffuse Beam
- Semiconcentrated beam with MAC/R reflector
- Concentrated beam with MAC/R AL reflector

# MARINER - Serie MAR-PLUS

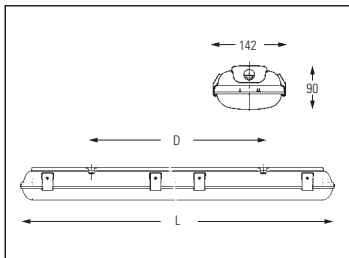

Type	Length L (mm)	Fixing Holes D (mm)
MAR/N 136	1270	900
MAR/N 158	1570	900
MAR/N 236	1270	900
MAR/N 258	1570	900
MAR/N 128	1270	900
MAR/N 154	1570	900
MAR/N 135	1270	900
MAR/N 149	1570	900
MAR/N 180	1570	900
MAR/N 228	1270	900
MAR/N 254	1570	900
MAR/N 235	1270	900
MAR/N 249	1570	900
MAR/N 280	1570	900

New concept waterproof fittings for T5 and T8 fluorescent types for total protection against the penetration of the foreign objects, water jets from any direction and accidental shocks.

Flame and combustion resistance in compliance EN 60598-1, totally self-extinguishing V2.

**Body:** Shatterproof polycarbonate (resisting shocks above 500J/sqm according to ASTM256), grey RAL 7035, self-extinguishing V2, features polyurethane foam seals applied without the use of Freon.

**Cover:** Transparent shatterproof self-extinguishing V2 polycarbonate, injection moulded anti-ageing UV-stabilised, with high-luminous efficiency linear prismatic reeding on the side. Completely smooth on the outside for easy cleaning.

**Clips:** Fiberglass-reinforced nylon with self-retaining hinged stainless steel joints. Available in INOX.

**Reflector:** Bonderised shaped sheet steel with high-reflection white stoved epoxy-polyester powder paint finish. Wiring is mounted to it. Remains attached to the fitting by suspension cord during maintenance.

Control gear and Electric circuit: 230V 50Hz; wired with heat resistant (HT 90 (C), fire retardant cable in compliance with IEC 20-22, with explosionproof capacitor, with built-in discharge resistor, with powerfactor correction, terminal block with sectioning fuse and cable grommet for wires up to 2,5 mm<sup>2</sup>.

Electronic version (EB) is available in T8 and T5. Emergency kit version (EES) is also available.

**Accessories:** Fittings supplied with D 6-12 mm gasket, cable grommet PG 13.5.

**Installation:** Ceiling mounted with hook or with rapid kit. Hook enclosed. ON NAL-NBL trunking system with NAL 1023 and Rapidkit.

Type	Lamp Type	Version	Box Qty	Pallet	Product Code
<b>MAR/N</b>		Class: I	<b>IP 65</b>		
CEI 34.21 / EN 60598		230V 50Hz	Class of temperature: T4		
MAR/N 136 H	1 x F36 T8	HPF - FUS	1	75	23277
MAR/N 158 H	1 x F58 T8	HPF - FUS	1	75	23280
MAR/N 236 H	2 x F36 T8	HPF - FUS	1	75	23281
MAR/N 258 H	2 x F58 T8	HPF - FUS	1	75	23278

Without lamp

<b>MAR/N EB</b>	<b>Electronico</b>	Class: I	<b>IP 65</b>		
CEI 34.21 / EN 60598		220-240V 50Hz	Class of temperature: T6		
MAR/N 136 EB	1 x F36 T8	HPF	1	75	23342
MAR/N 158 EB	1 x F58 T8	HPF	1	75	23344
MAR/N 236 EB	2 x F36 T8	HPF	1	75	23346
MAR/N 258 EB	2 x F58 T8	HPF	1	75	23349

With electronic ballast - Without lamp.

<b>MAR/N EB</b>	<b>Electronico</b>	Class: I	<b>IP 65</b>		
CEI 34.21 / EN 60598		220-240V 50Hz	Class of temperature: T6		
MAR/N 128 T5 EB	1 x F28 T5 HE	HPF	1	75	23444
MAR/N 154 T5 EB	1 x F54 T5 HO	HPF	1	75	23453
MAR/N 135 T5 EB	1 x F35 T5 HE	HPF	1	75	23458
MAR/N 149 T5 EB	1 x F49 T5 HO	HPF	1	75	23461
MAR/N 180 T5 EB	1 x F80 T5 HO	HPF	1	75	23465
MAR/N 228 T5 EB	2 x F28 T5 HE	HPF	1	75	23468
MAR/N 254 T5 EB	2 x F54 T5 HO	HPF	1	75	23470
MAR/N 235 T5 EB	2 x F35 T5 HE	HPF	1	75	23472
MAR/N 249 T5 EB	2 x F49 T5 HO	HPF	1	75	23476
MAR/N 280 T5 EB	2 x F80 T5 HO	HPF	1	75	23481

With electronic ballast - Without lamp.

Type	Lamp Type	Version	Box Qty	Pallet	Product Code
<b>MAR/N EES</b>		Class: I	<b>IP 65</b>		
CEI 34.21 / EN 60598		230V 50Hz	Class of temperature: T4		
MAR/N 136 EES	1 x F36 T8	HPF - FUS	1	75	23420
MAR/N 158 EES	1 x F58 T8	HPF - FUS	1	75	23421
MAR/N 236 EES°	2 x F36 T8	HPF - FUS	1	75	23434
MAR/N 258 EES°	2 x F58 T8	HPF - FUS	1	75	23437

With emergency battery - Without lamp.  
Only one lamp on emergency.

# MARINER - MAR/P series

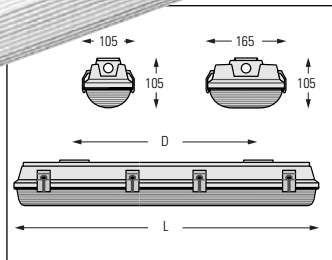
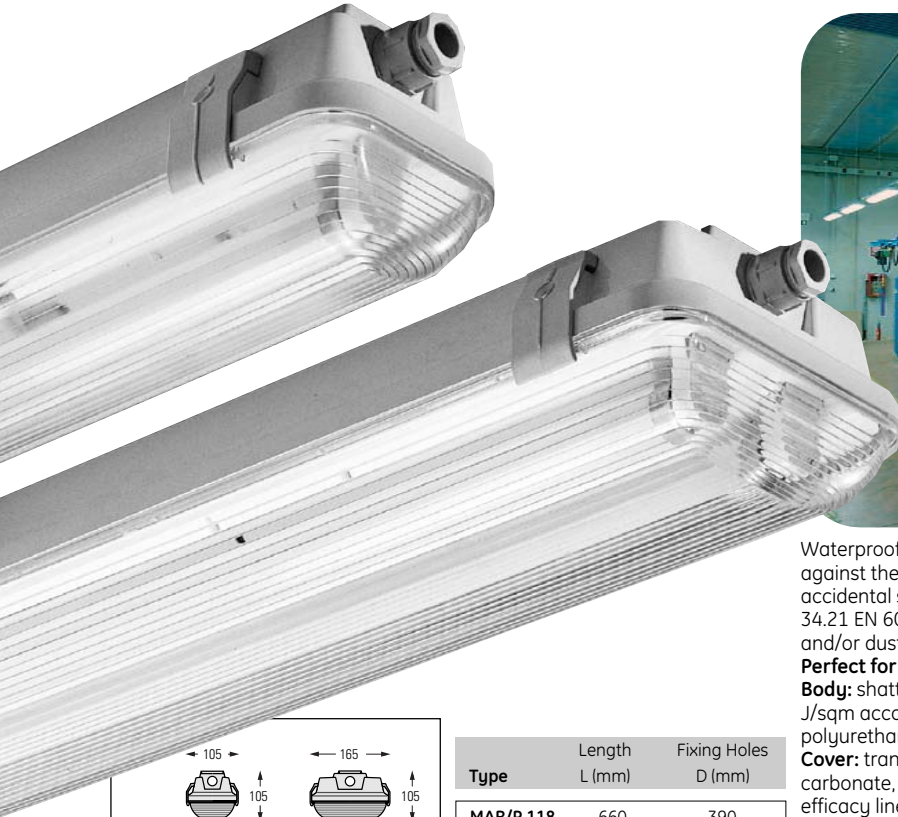

Type	Length L (mm)	Fixing Holes D (mm)
MAR/P 118	660	390
MAR/P 136	1270	900
MAR/P 158	1570	900
MAR/P 218	660	390
MAR/P 236	1270	900
MAR/P 258	1570	900

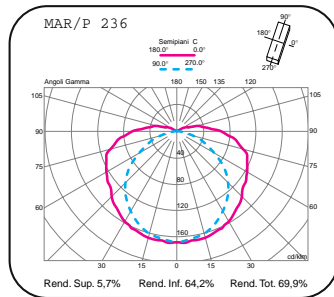
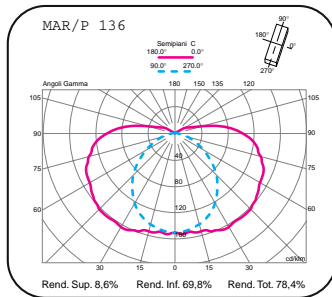

Waterproof ceiling fittings for T8 fluorescent lamps, for total protection against the penetration of foreign objects, water jets from any direction and accidental shocks. Flame and combustion resistance in compliance with IEC 34.21 EN 60598-1, totally self-extinguishing V2. Ideal for installation in humid and/or dusty areas.

**Perfect for AD-FT ambients with inflammability temperature > 150°C.**

**Body:** shatterproof Lexan® polycarbonate (resisting shocks above 500 J/sqm according to ASTM 256), grey RAL 7035, self-extinguishing V2; features polyurethane foam seals applied without the use of Freon.

**Cover:** transparent shatterproof self-extinguishing V2 Lexan® polycarbonate, injection moulded anti-ageing UV-stabilised, with high-luminous efficacy linear prismatic reeding on the inside. Completely smooth on the outside for easy cleaning.

**Clips:** fibreglass-reinforced nylon, with self-retaining hinged stainless steel joints. Supplied also with steel screws for tamper-proof fitting. Stainless steel clips are available on request.

**Reflector:** bonderised shaped sheet steel with high-reflection white stoved epoxy-polyester powder paint finish. Wiring is mounted to it. Remains attached to the fitting by suspension cords during maintenance.

Control gear and electric circuit: 230V 50Hz; wired with heat-resistant (HT 90°C), fire-retardant cable in compliance with IEC 20-22/II, with explosion-proof capacitor, with built-in discharge resistor, with power factor correction; terminal block with sectioning fuse and cable grommet for wires up to 2.5 mm<sup>2</sup>.

**Max. exterior surface temperature of casing:**

Type	T <sub>fn</sub> standard operation	Class of Temperature *
MAR/P 136/236 H	90°C	T4
MAR/P 158/258 H	100°C	T4

(\* According to Standard IEC 31-8 (in event of failure): T1 = 450°C; T2 = 300°C; T3 = 200°C; T4 = 135°C; T5 = 100°C; T6 = 85°C

**Standard accessories:** fittings supplied with D 21 mm gasket, cable grommet PG 13.5 and two nylon suspension rings.

**Installation:** 1) Ceiling mount with gasket or with RAPIDKIT accessory. 2) Pendant with rings enclosed. 3) On NAL trunking system with NAL 1023 accessory.

Type	N° and Lamp Type	Version	Weight (kg)	Pack Box	Qty. Pallet	Product Code
<b>MAR/P</b>	Class: I	230V 50Hz	<b>IP 65</b>			
			Class of Temperature: T4			
MAR/P 118 H	1 x F18 T8	HPF - FUS	1,70	1	121	7004173
MAR/P 136 H	1 x F36 T8	HPF - FUS	2,40	1	77	7004175
MAR/P 158 H	1 x F58 T8	HPF - FUS	3,50	1	77	7004177
MAR/P 218 H	2 x F18 T8	HPF - FUS	2,10	1	77	7004179
MAR/P 236 H	2 x F36 T8	HPF - FUS	3,80	1	44	7004181
MAR/P 258 H	2 x F58 T8	HPF - FUS	5,30	1	44	7004183

Without lamp.

Type	N° and Lamp Type	Version	Weight (kg)	Pack Box	Qty. Pallet	Product Code
<b>MAR/P EB</b>	Class: I	230V 50Hz	<b>IP 65</b>			
			Class of Temperature: T6			
MAR/P 118 EB	1 x F18 T8	HPF - FUS	1,55	1	121	30242
MAR/P 136 EB	1 x F36 T8	HPF - FUS	2,24	1	77	30243
MAR/P 158 EB	1 x F58 T8	HPF - FUS	2,92	1	77	30245
MAR/P 218 EB	2 x F18 T8	HPF - FUS	1,58	1	77	30248
MAR/P 236 EB	2 x F36 T8	HPF - FUS	3,14	1	44	30249
MAR/P 258 EB	2 x F58 T8	HPF - FUS	3,92	1	44	30253

With electronic ballast - **Without lamp.**

Note the resistance to chemical agents in construction materials. • HPF = with power factor correction • FUS = with fuse

Type	N° and Lamp Type	Version	Weight (kg)	Pack Box	Qty. Pallet	Product Code
<b>MAR/P H CL2</b>	Class:	230V 50Hz	<b>IP 65</b>			
			Class of Temperature: T4			
MAR/P 118 H CL2	1 x F18 T8	HPF - FUS	1,70	1	121	30294
MAR/P 136 H CL2	1 x F36 T8	HPF - FUS	2,40	1	77	30295
MAR/P 158 H CL2	1 x F58 T8	HPF - FUS	3,50	1	77	30297
MAR/P 218 H CL2	2 x F18 T8	HPF - FUS	2,10	1	77	30298
MAR/P 236 H CL2	2 x F36 T8	HPF - FUS	3,80	1	44	30300
MAR/P 258 H CL2	2 x F58 T8	HPF - FUS	5,30	1	44	30302

Without lamp.

Type	N° and Lamp Type	Version	Weight (kg)	Pack Box	Qty. Pallet	Product Code
<b>MAR/P H EES</b>	Class: I	230V 50Hz	<b>IP 65</b>			
			Class of Temperature: T4			
MAR/P 118 H EES*	1 x F18 T8	HPF - FUS	1,75	1	121	33627
MAR/P 136 H EES	1 x F36 T8	HPF - FUS	3,45	1	77	30224
MAR/P 158 H EES	1 x F58 T8	HPF - FUS	4,70	1	77	30227
MAR/P 218 H EES*	2 x F18 T8	HPF - FUS	2,55	1	77	30237
MAR/P 236 H EES*	2 x F36 T8	HPF - FUS	4,85	1	44	30239
MAR/P 258 H EES*	2 x F58 T8	HPF - FUS	6,50	1	44	30240

With emergency battery - **Without lamp.**

\*Wired for non-permanent operation.

\*Only one lamp on emergency.